



Goodwyn Mills Cawood
11 North Water Street
Suite 19290
Mobile, Alabama 36602
T 251.460.4006
F 251.460.4423

TRANSMITTAL COVER SHEET

DATE: November 24, 2025

TO: ALL CONTRACTORS

FROM: DENISE KING

PROJECT: WRIGHT SMITH WWTP PRIMARY DIGESTER NO.1 COVER REPLACEMENT
FOR THE BOARD OF THE WATER AND SEWER COMMISSIONERS OF THE CITY OF MOBILE,
ALABAMA
SRF PROJECT NO. CS010281-23
GMC PROJECT NO. CMOB250034

RE: ADDENDUM #1

PLEASE COMPLETE BELOW AND RETURN IMMEDIATELY.

Ashley Morris
Email: Ashley.Nobles@gmcnetwork.com

I, the undersigned, hereby acknowledge receipt of this Addendum.

Allyson Shipps
Authorized Representative of Contractor

11/24/2025
Date

Shmidt Environmental Construction, Inc.
Company Name

334-887-0334
Telephone

47519
Contractor's License Number (if applicable)



ADDENDUM NUMBER 1

WRIGHT SMITH WWTP PRIMARY DIGESTER #1 COVER REPLACEMENT

FOR THE BOARD OF WATER AND SEWER COMMISSIONERS OF THE CITY OF MOBILE

GMC PROJECT NO. CMOB250034

1. General

- 1.1 The following revisions are hereby added as Addendum No. 1 to the referenced Project Manual and Plans and shall be considered when preparing bids.

2. Revisions to Project Manual

- 2.1 The detail for the new stairs for Primary Digester #1 has been revised and the revised drawing is included as an attachment to this addendum.
- 2.2 Bidders shall, at minimum, hold a current major classification of its General Contractor's License of Municipal & Utility – Specialty Construction (MU-S).
- 2.3 Revised **Proposal** is attached and should be submitted with bid.
- 2.4 Revised **Section 10 Special Provisions** attached.

3. Questions

- 3.1 **Question: In reference to the subject project, will the GC be allowed to stage the removal of the existing digester cover and assembly of the new cover in areas that are outside of the "Contractor's Designated Area" shown on G-101? As crane access and capabilities are limited, we need to understand what we have to work with to get our work as close to the digester as possible. Specifically, we would like to use the area southwest of Primary Clarifier No. 3. The area that is west of Primary Clarifier No. 2 is also of interest but further away from the work than the afore mentioned area.**

Answer: The Contractor may stage the assembly of the digester cover in an alternate location outside of the area indicated on G-101. The Owner will work with the Contractor to accommodate an alternate staging area as much as possible and to the extent that existing plant operations aren't adversely affected.

- 3.2 **Question: We will need some clarification on how the material is being classified, sludge or rock/sand? There will be no way possible not to have sludge in the rock/sand and the same for having rock/sand in the sludge. The entire contents of the digester should be by the dry ton as sludge/grit/rags/sand/rock/etc. You send a daily composite sample from the belt press and use the total solids and scale tickets to determine total dry tons processed each day. Trying to separate into 2 waste streams will be impossible.**

Answer: The bid form and the 'Basis of Payment and Method of Measure' section of Section 10 – Special Provisions have been revised to remove the rock and sand removal line item. All material removed shall be included in the 'Sludge Removal & Disposal' line item.



4. Attachments

- 4.1 Proposal – Addendum 1
- 4.2 Revised Section 10 Special Provisions
- 4.3 Revised Plans :
 - D-001 Process Site
 - D-101 Cover & Mixing System Plan
 - D-103 Enlarged Plan & Section

5. Acknowledgement of Receipt

- 5.1 Receipt of Addendum No. 1 shall be acknowledged in two ways:
 - 5.1.1 Note on (EJCDC C-410) the Bid Form of the Project Manual – Bidder acknowledges receipt of “Addendum No. 1” and date of “November 24, 2025”.
 - 5.1.2 EMAIL GMC immediately at ashley.nobles@gmcnetwork.com and confirm that addendum has been received and is legible.

6. Conclusion

- 6.1 This is the end of Addendum Number 1, dated Monday, November 24, 2025.

BID PROPOSAL ADDENDUM NO.1

**PROJECT: Wright Smith WWTP
 Primary Digester #1 Cover Replacement
 Mobile Area Water and Sewer System
 Mobile, Alabama
 SRF PROJECT NO. CS010281-23
 GMC PROJECT NO. CMOB25034**

BIDDER: _____

Bidder agrees to perform the work described in the plans and specifications for the following lump sum prices:

BASE BID

<u>ITEM</u>	<u>QTY</u>	<u>UNIT</u>	<u>DESCRIPTION</u>	<u>UNIT PRICE</u>	<u>TOTAL PRICE</u>
1	1	LS	Mobilization & General Conditions	\$ LS	\$
2	1	LS	Demolition	\$ LS	\$
3	1	LS	Furnish and Install Fixed Digester Cover	\$ LS	\$
4	1	LS	Furnish and Install Plunger Mixer	\$ LS	\$
5	1	LS	High Performance Coatings	\$ LS	\$
6	1	LS	Metal Stairs	\$ LS	\$
7	1	LS	Electrical	\$ LS	\$
8	1	LS	Erosion Control & Site Restoration	\$ LS	\$
9	50	DRY TONS	Sludge Removal & Disposal from Digester	\$	\$
10	1	LS	All Other Items	\$ LS	\$
11	1	LS	SCADA & Integration Allowance	\$ LS	\$ 9,000.00
12	1	LS	Owner's Contingency Allowance	\$ LS	\$ 100,000.00
TOTAL BASE BID					\$

ADDENDUM NO.1

Board of Water and Sewer Commissioners
of the
City of Mobile, Alabama

Update of Standard Specifications
Section 10

Special Provisions

Updated May 2021

TABLE OF CONTENTS

PART 1 GENERAL..... 1

10.1.01 ALABAMA ACT NO. 84-228..... 1

10.1.02 REVISIONS 2

10.1.03 REFERENCED SECTIONS 2

10.1.04 REFERENCED CODES AND STANDARDS..... 2

10.1.05 SMALL AND SMALL UNDERUTILIZED BUSINESSES 2

10.1.06 STATE HIGHWAY OR RAILROAD PERMITS 2

10.1.07 PERMITS, CERTIFICATES, LAWS AND ORDINANCES 2

10.1.08 WAGE RATES 3

10.1.09 SEQUENCE OF OPERATIONS 3

10.1.10 PROJECT DOCUMENTATION 3

10.1.11 REPORTS, RECORDS AND DATE..... 4

10.1.12 SIGNS 4

10.1.13 CONSTRUCTION WITHIN STATE HIGHWAY RIGHT-OF-WAY 4

10.1.14 CUTTING OF TREES WITHIN PUBLIC RIGHTS-OF-WAY 4

10.1.15 DEWATERING 4

10.1.16 WEATHER CONDITIONS 4

10.1.17 LOCKS AND KEYS..... 5

10.1.18 TIGHTNESS OF WATER CONTAINING WALLS..... 5

10.1.19 EXTENSION OF CONTRACT TIME..... 5

10.1.20 CLEAN-UP 5

10.1.21 BRANDS OF EQUIPMENT AND MATERIALS 5

10.1.22 AFFIDAVIT OF COMPLIANCE 5

10.1.23 SUPERVISION OF INSTALLATION AND THE GUARANTEE..... 6

10.1.24 MANUFACTURER’S CERTIFICATION..... 6

10.1.25 MAXIMUM TRENCH WIDTH 6

10.1.26 BASIS OF PAYMENT AND METHOD OF MEASURE:..... 6

10.1.27 SPECIAL HANDLING OF PURCHASE ORDERS¹..... 16

10.1.28 BYPASS PUMPING..... 16

PART 1 GENERAL

10.1.01 ALABAMA ACT NO. 84-228

- A. Contractors shall comply with the requirement of Act No. 84-228 of the Legislature of the State of Alabama. Particular attention is directed to Section 2 of Act. No. 84-228 which requires submission of certain documents with the bid documentation and failure to submit such documents may be cause for rejection of the Contractor's bid.
- B. As a convenience to bidders, the law is presented below; however, it shall be the Contractor's responsibility to satisfy himself as to the responsibilities under the law.
 - 1. ALABAMA LAW (Regular Session, 1984) - Act No. 84-228 - S. 135-Senators Foshee, and Teague - AN ACT
- C. Relating to contracts and contractors; to give preference to resident contractors who bid on public work projects except where federal funds are involved.
- D. Be it Enacted by the Legislature of Alabama:
 - 1. Section 1. In the letting of public contracts in which any state, county or municipal funds are utilized, except those contracts funded in whole or in part with funds received from a federal agency, preference shall be given to resident contractors and a nonresident bidder domiciled in a state having laws granting preference to local contractors shall be awarded Alabama public contracts only on the same basis as the nonresident bidder's state awards contracts to Alabama contractors bidding under similar circumstances; and resident contractors in Alabama as defined in Section 39-2-12, Code of Alabama 1975, be they corporate, individuals or partnerships, are to be granted preference over nonresidents in awarding of contracts in the same manner and to the same extent as provided by the laws of the state of domicile of the nonresident.
 - 2. Section 2 Nonresident bidders must accompany any written bid documents with a written opinion of an attorney at law licensed to practice law in such nonresident bidder's state of domicile, as to the preferences, if any or none, granted by the law of that state to its own business entities whose principal places of business are in that state in the letting of any or all public contracts.
 - 3. Section 3. A summary of this law shall be made a part of the advertised Specifications of all projects affected by this law.
 - 4. Section 4. The provisions of this Act are severable. If any part of this Act is declared invalid or unconstitutional, such declaration shall not affect the part which remains.
 - 5. Section 5. All laws or parts of laws which conflict with this Act are hereby repealed.
 - 6. Section 6. This Act shall become effective immediately upon its passage and approval by the Governor, or upon its otherwise becoming law.
 - a. Approved April 30, 1984 Time: 4:30 P.M.

10.1.02 REVISIONS

- A. These specifications will be modified and updated as required to keep abreast of current technologies, industry standards, regulatory agency requirements, and best management practices. It shall be the responsibility of the end user of these Guide Specifications to insure the latest and most current revision is applied to the project.

10.1.03 REFERENCED SECTIONS

- A. Section 5 – Control of Work
- B. Section 8 – Prosecution and Progress
- C. Section 12 – Sanitary Sewer Standard Specifications
- D. Appendix F – Project Sign Detail
- E. Appendix I – Trench Widths and Paving Cut-Backs

10.1.04 REFERENCED CODES AND STANDARDS

- A. State of Alabama Highway Department - Standards for Accommodating Utilities on Highway Rights-of-Way
- B. Federal Specification QQ-B-71a – Steel for Concrete Reinforcement
- C. AWWA C105 – Polyethylene Encasement for Ductile Iron Pipe Systems

10.1.05 SMALL AND SMALL UNDERUTILIZED BUSINESSES

- A. The Board’s Small and Underutilized Business office will assist Bidders upon request in meeting the requirements of the Contract.

10.1.06 STATE HIGHWAY OR RAILROAD PERMITS

- A. Where a pipe is to be laid along or under a State Highway or railroad, the Contractor shall furnish the Highway Department or railroad company with bonds and insurance as required to secure a permit. The cost of bonds and insurance will be borne by the Contractor.

10.1.07 PERMITS, CERTIFICATES, LAWS AND ORDINANCES

- A. The Contractor shall, at his own expense, procure all permits, certificates and licenses required of him by law for the execution of his work. He shall comply with all federal, state, and local laws, ordinances and rules and regulations relating to the performance of the Work.
- B. The Contractor shall also comply with Ordinance 55-012 “An Ordinance Regulating All Excavation Work of Existing Streets and Improvements Within Public Rights-of-Ways,” adopted by the Board of Water and Sewer Commissioners of the City of Mobile, Alabama, April 3, 1970.

10.1.08 WAGE RATES

- A. The construction of said Project shall in all respects conform to all applicable requirements of federal, state and local laws and ordinances.

10.1.09 SEQUENCE OF OPERATIONS

- A. The Contractor shall start at the point or points designated by the Owner and shall proceed with the sequence of construction as the Owner directs. The Contractor shall provide sufficient crews to lay pipe and complete the job within the time specified. In general, each line shall be laid, tested and placed in service before another line is started.

10.1.10 PROJECT DOCUMENTATION

- A. General: Prior to start of construction, the project right-of-way or easement shall be documented by the use of photographs or videotapes. Pictures (photo or video), in color, shall be taken at 100 feet on centers and shall be taken along the centerline of the Project looking up station. At least one station marker shall be visible for identification purposes and station markers shall be set up by the Contractor. During the course of documentation, any features or items of interest or importance which may be encountered shall be photographed or videotaped. Prints or tapes shall be delivered to the Engineer within one week after they are made.
- B. Photographs: Clear, legible photographs shall be taken by a skilled technician using a wide angle lens. Each photograph shall be identified on the back with Project number, location, date and time of day that photograph was taken. One color print approximately 4" x 6" and the negative shall be delivered to the Engineer.
- C. Videotapes: The purpose of the videotape recordings shall be a supply of continuous visual and audio record of problem areas, items, and features found within any particular area. This videotape record may be supplemented with photographs to exactly identify and locate specific bad features or items.
 - 1. The videotape recordings shall be capable of recording and reproducing a picture having not less than 500 lines of resolution. The videotape recorder shall be one on which both sound and video information can be recorded utilizing a VHS video cassette system. The videotape recording shall be made on magnetic tape which shall produce a visual image equal to or better than the quality of the picture on a television monitor. The replay of the recorder video information, when reviewed on a monitor/receiver, shall be free of electrical interference and shall produce clear, stable images. To ascertain that the equipment to be used in this Work meets the stated minimum requirements, a videotape of a suitable test pattern will be required prior to initiation of Work.
 - 2. The audio portion of the composite signal shall be sufficiently free of electrical interference and background noise to provide an oral report that is clear and completely and easily discernible. The audio portion of the tape report shall be recorded by the operating technician on the audio-video tapes as they are being produced and shall include the location or identification of the section being viewed, the station-to-station direction of travel, the distance traveled on the specific run, and any problems encountered.

3. Videotape recordings shall be enclosed in a vinyl plastic container which shall clearly indicate the date the tape was taken, and the designated section(s) of the Project contained on the tape.

4. There shall be no separate payment for photographic and/or videotape work.

10.1.11 REPORTS, RECORDS AND DATA

A. The Contractor and each of his subcontractors shall submit to the Owner such schedules of quantities and costs, progress schedules, payrolls, reports, estimates, records, and other data as the Owner may request concerning work performed or to be performed under this Contract.

10.1.12 SIGNS

A. Before starting and during construction on any Project, the Contractor shall place at both ends of the section signs approximately 8 feet long by 4 feet high. The signs shall be worded approximately as shown in Appendix F.

10.1.13 CONSTRUCTION WITHIN STATE HIGHWAY RIGHT-OF-WAY

A. The requirements of the State of Alabama Highway Department “Standards for Accommodating Utilities on Highway Rights-of-Way” are hereby made a part of these Specifications for all utility construction within rights-of-way for roads or highways under the jurisdiction of the State of Alabama Highway Department.

10.1.14 CUTTING OF TREES WITHIN PUBLIC RIGHTS-OF-WAY

A. The Contractor shall obtain a permit from the Mobile Tree Commission prior to trimming or removing any trees located within public rights-of-way. When large tree limbs and roots are encountered, the Contractor shall take precautions to protect by tunneling, or pushing the pipe under the roots so as not to damage them. No additional payment shall be made for this Work, but it shall be included in the unit price bid for related items.

10.1.15 DEWATERING

A. The Contractor shall remove any water which may be found or may accumulate in the trenches and shall perform all work necessary to keep them clear of water while the foundations are being laid, the masonry being constructed, or pipe laying is in progress. Such removal shall be accomplished by means of a well point system or other approved means. Comprehensive plans for dewatering operations, if used, shall be submitted prior to installation. No extra payment will be made for dewatering.

10.1.16 WEATHER CONDITIONS

A. In the event of temporary suspension of work or during inclement weather, or whenever the Owner shall direct, the Contractor will, and will cause his subcontractor to protect carefully his and their Work and materials against damage or injury from weather. If any work or materials shall have been damaged or injured by reason of failure on the part of the Contractor or any of his subcontractors to protect his work, such materials shall be removed and replaced at the expense of the Contractor.

10.1.17 LOCKS AND KEYS

- A. All locks to be furnished under this Contract shall be keyed alike and 5 keys shall be delivered to the Engineer for distribution to the Owner. Padlocks shall be furnished by the Owner except where noted otherwise on the Plans and in these Specifications.

10.1.18 TIGHTNESS OF WATER CONTAINING WALLS

- A. All basins and tanks are hydraulic structures and shall be watertight. Each tank shall be filled with water to full depth and kept full 24 hours for observation. The Contractor shall exercise every precaution to secure watertightness by careful mixing and placing of the concrete so as to obtain a homogeneous mixture at maximum density, without air pockets or voids, using the minimum practical amount of water in the mix. Extreme care shall be used to secure continuity of water stops at expansion and construction joints, sealing off holes from wall ties, etc., and thoroughly placing concrete about wall sleeves, wall pipes and other obstructions. The Contractor shall fix all leaks. The Contractor shall furnish test water at his own expense.

10.1.19 EXTENSION OF CONTRACT TIME

- A. Unless specifically waived by the Owner, when an extension of contract time is granted by the Owner to the Contractor to complete the Work under this Contract, the Contractor shall pay any additional engineering Cost or other Cost accrued to the Owner as a result of the extension of time granted.
- B. The requirements of Specification Paragraph 5.14, Paragraph 5.15 and Paragraph 8.10 will be strictly adhered to upon completion of the Work.

10.1.20 CLEAN-UP

- A. The job shall be kept clean at all times. Loose dirt shall not be allowed to clog ditches or cover sidewalks. Soft clay or other undesirable material removed from the trenches shall be removed from the streets, sidewalks or ditches. The Owner reserves the right to demand that the Contractor's forces be diverted to this clean-up at any time that condition of streets, driveways, sidewalks, or private property warrants such diversion. Such diversion of Contractor's forces will not entitle the Contractor to any extension of time or additional compensation.

10.1.21 BRANDS OF EQUIPMENT AND MATERIALS

- A. When referenced the name of a certain brand, make or manufacturer is to denote the quality standard of the equipment or material, and is to convey the general style, type, character and quality. Whenever a material or article required is specified or shown on the Plans by using the proprietary product or of a particular manufacturer or vendor, any material or article which will meet the design criteria and is equal in function and durability as determined by the Engineer will be considered.

10.1.22 AFFIDAVIT OF COMPLIANCE

- A. Suppliers of pipe and fittings shall furnish in triplicate to the Owner, an affidavit stating that all pipe and fittings furnished under this Contract conform to the

requirements as set forth in these Specifications. Unless specified otherwise, all materials shall be new, unused and without defect.

10.1.23 SUPERVISION OF INSTALLATION AND THE GUARANTEE

- A. The Contractor shall employ a factory trained engineer to supervise the installation and alignment of all items of mechanical and electrical equipment. He shall see that all items of equipment are installed, piped, and wired, meeting the requirements of the Plans and Specifications and in accordance with the manufacturer's recommendations. The Contractor shall place all equipment in satisfactory operation and demonstrate such. The Contractor shall guarantee the satisfactory operation of all apparatus and machinery against defects in workmanship, material, and installation for a period of one year from the date of final acceptance. The Owner will give notice of observed defects with reasonable promptness and the Contractor shall remedy any defects in the Work and pay for any damage to other work resulting therefrom. Neither the final certificate of payment nor any provision in the Contract Documents nor partial or entire use or occupancy of the premises by the Owner shall constitute an acceptance of work not done in accordance with the Contract Documents, or relieve the Contractor of liability in respect to any express warranties or responsibility for faulty materials or workmanship.
- B. The manufacturer's representatives shall submit to the Engineer in writing a document stating the Contractor has installed the equipment properly and in accordance with the manufacturer's recommendations.

10.1.24 MANUFACTURER'S CERTIFICATION

- A. To assure that manufacturers and suppliers are aware of the use to which their equipment and products will be subjected, the Contractor shall require the manufacturer or manufacturer's representative to place the following certification on submittal data transmittals:
 - 1. "This is to certify that we have examined the Plans and Specifications for this Project and have ascertained that this equipment or material is suitable for the Purpose and use intended. _____ Authorized Signature"

10.1.25 MAXIMUM TRENCH WIDTH:

- A. The maximum trench widths set the limit of payment for various items listed in Paragraph 10.1.26, "Basis of Payment and Method of Measure." The maximum trench widths and typical paving cut-backs which are applicable to these Specifications are shown in Appendix I.

10.1.26 BASIS OF PAYMENT AND METHOD OF MEASURE:

- A. General:
 - 1. The lump sum and unit price bid for the various items shall be compensation in full for furnishing all materials, labor, equipment, and incidentals for the item in place complete in every detail. There will be no direct payment for clearing, excavating, bracing, caulking, backfilling, clean-up, restoration of property, testing or other items of work necessary for the installation of the item.

B. Bid Items

1. **Mobilization and General Conditions:** The price bid for this item shall include all costs associated with mobilization, bonds, insurance, and other general conditions.
2. **Demolition:** The price bid for this item shall include all costs associated with removal of the existing digester cover.
3. **Furnish and Install Fixed Digester Cover:** The price bid for this item shall include all costs associated with the purchase and installation of the digester cover.
4. **Furnish and Install Plunger Mixer:** The price bid for this item shall include all costs associated with the purchase and installation of the plunger mixer.
5. **High Performance Coatings:** The price bid for this item shall include all costs associated with the application, inspection and testing of coatings applied in this project.
6. **Metal Stairs:** The price bid for this item shall include all costs associated with the installation of the new stairs for the digester.
7. **Electrical:** The price bid for this item shall include all electrical work in the project.
8. **Erosion Control & Site Restoration:** The price bid for this item shall include all costs associated with erosion control measures and returning the site to original condition.
9. **Sludge Removal & Disposal from Digester:** The unit price bid for this item shall include the removal, dewatering, and landfill disposal of 1 dry ton of sludge in the digester. The contents of the material removed is unknown and could include grit, sand, rock, rags, etc. A daily composite sample taken from the press along with scale tickets shall be used to determine the total dry tons processed.
10. **All Other Items:** The price bid for this item shall include any other item not included in Items 1 – 10, including, but not limited to, special inspections (welding, painting, etc.), testing, cleaning of the digester, piping, building permit and electrical permit.

10.1.27 SPECIAL HANDLING OF PURCHASE ORDERS¹

- A. The Board of Water and Sewer Commissioners is exempt from City, County, State and Federal sales tax for any hardware, equipment, and materials purchased for the installation of Capital projects. Contractors shall take this into consideration when preparing bids for capital projects. To ensure there are no taxes charged, Contractors are directed to do the following:
- B. Contractor shall contact the Alabama Revenue Department and apply for a tax exempt certificate for the specific project. The phone number for the Mobile office is 334-344-4737. The web site that explains the rules and regulations for tax exemption is www.ador.state.al.us, rule number 810-6-5.02.

1. Contractor shall mail copies of the tax exempt certificate to all suppliers of all hardware, equipment, and material.
- C. Contractor shall state on each purchase order to the supplier that material, equipment, and hardware for installation owned and operated by the Board of Water and Sewer Commissioners of the City of Mobile are exempt from County and State sales tax as per the number on the certificate of exemption.

10.1.28 BYPASS PUMPING

- A. The Contractor shall submit three (3) copies of a Bypass Pumping Plan as required in Section 12.1.26 to the Engineer for review prior to proceeding with bypassing operations. Bypassing operations shall not commence until a Bypass Pumping Plan is reviewed by the Engineer.
- B. The Contractor shall be responsible for and shall indemnify and hold the Owner harmless for any sanitary sewer overflow occurring as the result of the work performed. The Contractor is responsible for any sewer discharge to the surface due to failure in bypass hose, piping or other equipment. Any discharge from air release valves shall be contained. The Contractor shall ensure that raw sewage will not spill on the ground or into any bodies of water, channel, or conduits of conveyance of storm water during the performance of this work. Prior to removal of the bypass pumping pipe, the Contractor shall empty all sewage into the sewer system. The Contractor is responsible for and shall indemnify and hold the Owner harmless for any sanitary sewer discharge to the environment due to a failure in the equipment and/or bypassing operation.
- C. In the event of a sanitary sewer overflow, the Contractor shall contact the Owner's representative immediately and complete the Contractor Unpermitted Discharge Reporting Form provided by the Owner. If there is a sanitary sewer discharge to the environment due to a failure in the equipment and/or bypassing operation, the Contractor shall reimburse the Owner all costs related in any way to compliance with laws, regulatory requirements, and/or court orders and decrees associated with the overflow or discharge event. The costs include, but not limited to, water quality

monitoring, signage, cleanup, fines, legal fees, claims, and reporting. In the event that the peak flows during the bypass pumping operation exceed the projected peak flow figures previously provided by the Owner and a sanitary sewer overflow event occurs when the Contractor's equipment is operating correctly, the Contractor will not be held liable for the sanitary sewer overflow or discharge.

- D. The Contractor shall be liable for and shall indemnify and hold the Owner harmless for any other claims made as a result of the sanitary sewer discharge or sanitary sewer overflow due to a failure in the equipment and/or bypassing operation and shall be responsible for all requirements imposed by the regulatory agencies. In addition, the Contractor shall provide notification consisting of one (1) quarter page advertisement published in the Mobile Register within 3 days of the sanitary sewer overflow. The advertisement shall be written in a manner reasonably designed to inform fully the customers of the Owner. The notice shall be conspicuous and shall not use unduly technical language, unduly small print or other methods which would frustrate the purpose of the notice. The notice shall disclose all material facts regarding the subject including the amount of the overflow, when the overflow occurred, any potential adverse health effects, the population at risk, reasonably known methods of mitigation known, and steps being taken to mitigate problems with the by-pass pumping operation. Each notice shall contain the name, business address, and telephone number of the Contractor.

END OF SECTION



PROCESS NOTES:

1. PROCESS EQUIPMENT DIMENSIONS, LOCATIONS, AND PIPING SYSTEM LAYOUTS SHOWN ON THE DRAWINGS ARE BASED ON EQUIPMENT SELECTED BY ENGINEER AND INFORMATION AVAILABLE TO ENGINEER. CONTRACTOR SHALL VERIFY FIELD CONDITIONS, ACTUAL EQUIPMENT DIMENSIONS AND INSTALLATION REQUIREMENTS BASED ON SHOP DRAWINGS, AND ALL NECESSARY DETAILS FOR COMPLETE INSTALLATION.
2. EQUIPMENT ARRANGEMENTS ARE BASED ON THE EQUIPMENT BASIS OF DESIGN IN THE SPECIFICATIONS. CHANGES TO THE LISTED BASIS OF DESIGN RESULTING IN DIFFERENCES OF THE SHOWN ARRANGEMENT SHALL BE THE CONTRACTORS RESPONSIBILITY. NO PAYMENT WILL BE ISSUED TO THE CONTRACTOR FOR MODIFICATIONS TO THE LAYING LENGTH, CONCRETE LAYOUT, ELECTRICAL OR MECHANICAL REQUIREMENTS, ETC.
3. VALVES, PIPES, MOTORS, ELECTRICAL PANELS, ETC. SHALL BE POSITIONED SO THAT THEY DO NOT INTERFERE WITH PEDESTRIAN TRAFFIC.
4. ALL ELECTRICAL APPURTENANCES AND EQUIPMENT SHOWN ON THIS SHEET AND EXCLUDED FOR CLARITY SHALL BE COORDINATED WITH THE ELECTRICAL PLANS AND SPECIFICATIONS.
5. ALL STRUCTURAL ENTITIES SHOWN ON THIS SHEET AND EXCLUDED FOR CLARITY SHALL BE COORDINATED WITH THE STRUCTURAL PLANS AND SPECIFICATIONS.
6. DRAWINGS MAY NOT SHOW ALL VALVES, GAUGES, SWITCHES, OPERATORS, DRAINS, VENTS, ETC., REQUIRED FOR THE COMPLETE SYSTEM. CERTAIN SMALL DIAMETER PROCESS PIPING RUNS MAY NOT BE SHOWN IN THEIR ENTIRETY. GENERALLY, NOT EVERY FITTING AND OFFSET IS SHOWN. SOME VALVES AND APPURTENANCES MAY BE OMITTED FOR THE SAKE OF CLARITY. THE CONTRACTOR SHALL FURNISH, INSTALL, AND TEST ALL PIPING SYSTEMS AS INDICATED ON THE PROCESS SYSTEM FLOW SCHEMATICS AND/OR AS DEFINED IN THE SPECIFICATIONS AND/OR AS REQUIRED TO PROVIDE THE COMPLETE SYSTEM.
7. FOR PIPING INDICATED REQUIRING INSULATION AND/OR HEAT TRACING, REFER TO SECTIONS 40 42 13 - PROCESS PIPING INSULATION AND/OR 40 41 13 - PROCESS PIPING ELECTRICAL RESISTANCE HEAT TRACING

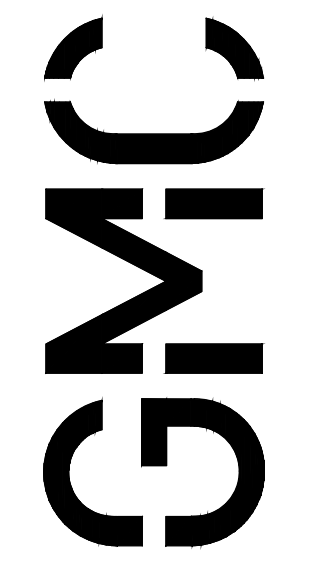

11 North Water Street
 Suite 19290
 Mobile, AL 36602
 T 251.460.4006



ISSUE	DATE
50% SUBMITTAL:	07.16.2025
90% SUBMITTAL:	09.19.2025
BID SET:	10.10.2025
ADDENDUM 1:	11.19.2025

ENGINEER:	DT
DESIGNER:	DT
DRAWN BY:	CE

WRIGHT SMITH WWTP
 PRIMARY DIGESTER #1
 COVER REPLACEMENT
 MOBILE, AL
 MOBILE AREA WATER & SEWER SYSTEM
 CMOB250034

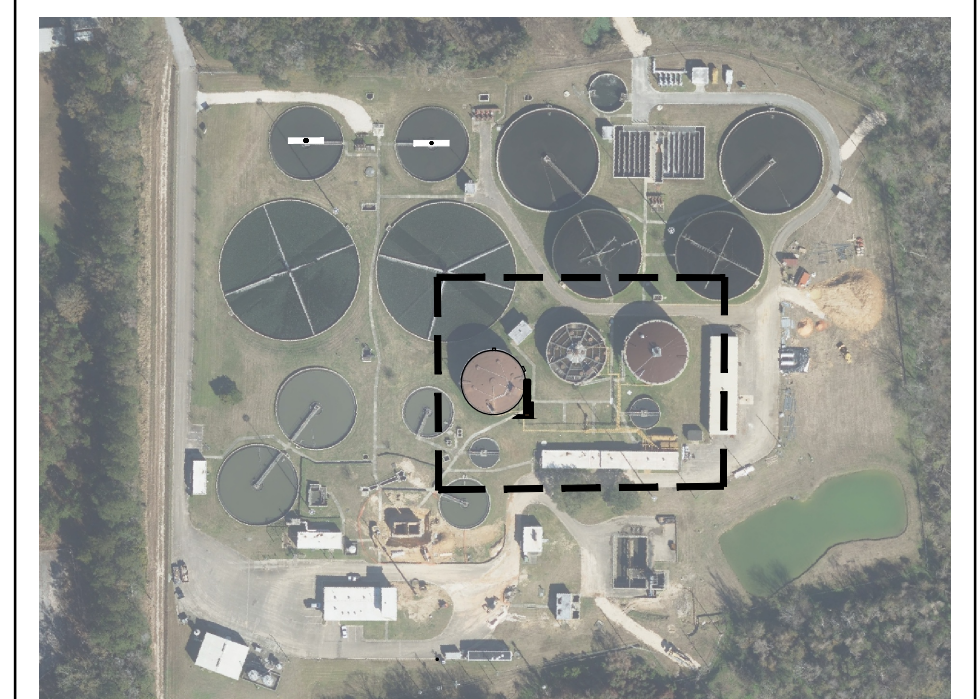

PROCESS SITE
 PLAN
 D-001

1 PLAN
 G-101 SCALE: 1" = 20'

DRAWING FILE: C:\Users\dmillic\OneDrive\GMC\MOB250034 Wright Smith WWTP Primary Digester #1 Cover Replacement\CAD Files\DWG\02 Sheets\11 Process\0-001.dwg
 PLOTTED: Nov 19, 2025 - 3:38pm

DRAWING FILE: C:\Users\dmill\OneDrive\GMC\Projects\Wright Smith WWTP Primary Digester #1 Cover Replacement\CAD Files\DWG\02 Sheets\11 Process\101.dwg
PLOTTED: Nov 19, 2025 - 3:40pm

1 PLAN FLOOR VIEW
D-101 SCALE: 3/16" = 1'-0"

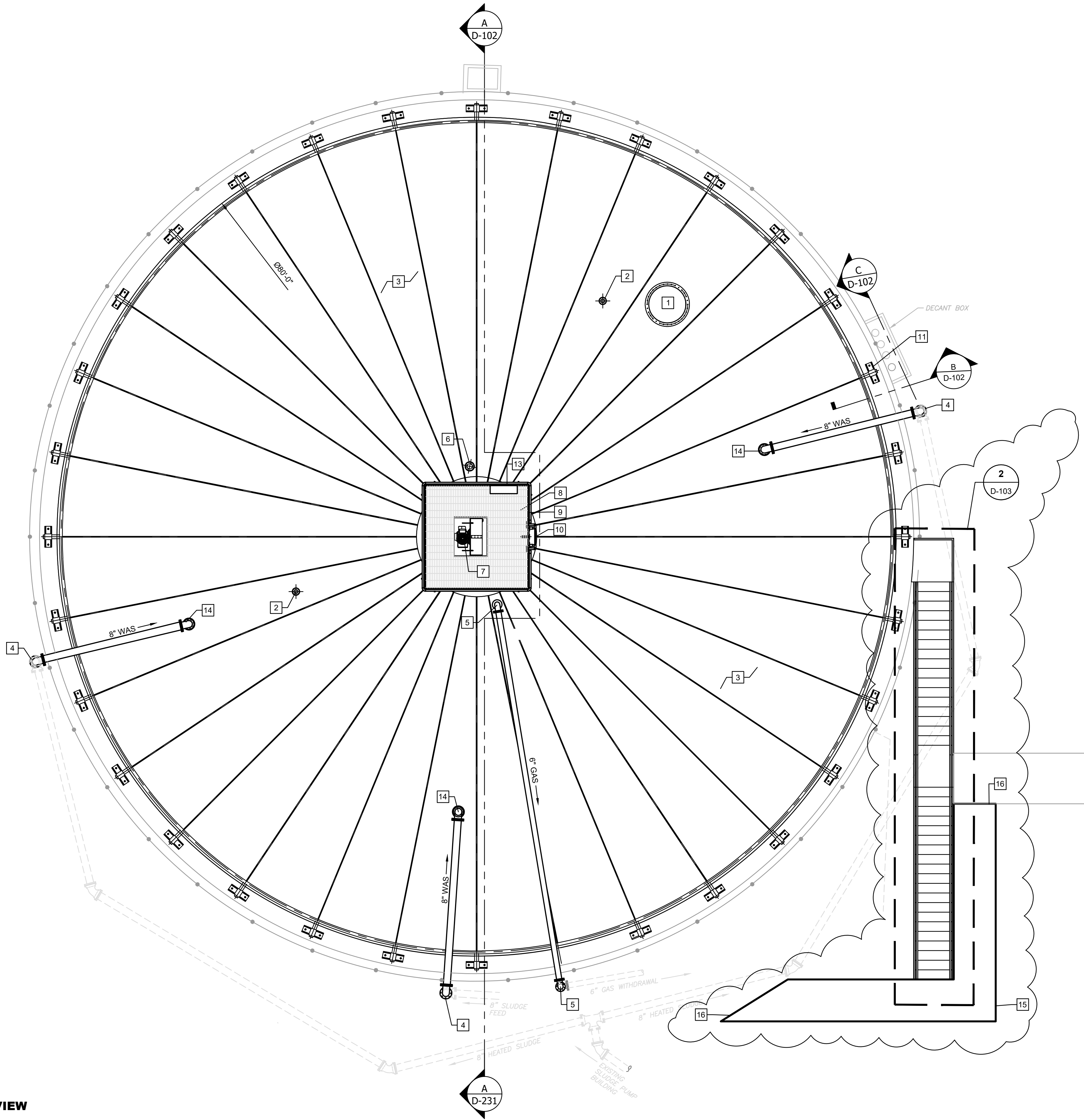

NOTES:

1. ALL COVER PENETRATIONS SHALL BE GASTIGHT.
2. CONTRACTOR SHALL PROVIDE ALL NECESSARY PIPE SUPPORTS. PIPE SUPPORT SHALL CONSIST OF 304 STAINLESS STEEL BASE (WELDED TO COVER) WITH 304 STAINLESS STEEL BASE U-BOLTS TO STRAP PIPE TO SUPPORT BASE.
3. ANY HANDRAIL ON TOP OF THE DIGESTER REMOVED OR DAMAGED DURING CONSTRUCTION SHALL BE REPLACED BY THE CONTRACTOR AFTER NEW COVER IS INSTALLED.

KEY NOTES: #

1. 42" ACCESS MANHOLE WITH SELF-LOCKING FOOT PEDAL.
2. 8" SAMPLE PORT W/ QUICK OPENING COVER
3. RADIAL BEAM, FIXED DOME STYLE COVER
4. 8" FL 90° BEND (CONNECT TO EXISTING 8" SLUDGE INFLUENT PIPING.)
5. 6" FL 90° BEND
6. 6" FLANGED NOZZLE FOR GAS SAFETY EQUIPMENT
7. MIXER (MOUNTED ON COVER)
8. ALUMINUM BAR GRATING
9. 3'-6" ALUMINUM HANDRAIL W/ TOE PLATE
10. LADDER
11. MODIFY OUTRIGGER AS REQUIRED TO ACCOMMODATE DECANT BOX.
12. 6" BLIND FLANGE
13. MIXER CONTROL PANEL (SEE ELECTRICAL)
14. 8" FL 90° BEND
15. NEW CONCRETE SIDEWALK
16. CONNECT TO EXISTING SIDEWALK

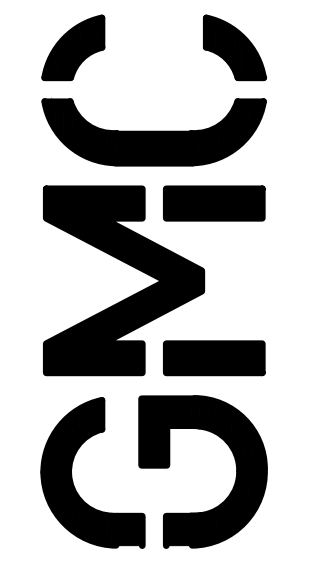

11 North Water Street
Suite 19290
Mobile, AL 36602
T 251.460.4006

ISSUE	DATE
50% SUBMITTAL:	07.16.2025
90% SUBMITTAL:	09.19.2025
BID SET:	10.10.2025
APPENDUM 1	11.19.2025

ENGINEER:	DT
DESIGNER:	DT
DRAWN BY:	CE

WRIGHT SMITH WWTP
PRIMARY DIGESTER #1
COVER REPLACEMENT
MOBILE, AL
MOBILE AREA WATER & SEWER SYSTEM
CMOB250034



**PRIMARY DIGESTER #1
COVER & MIXING
SYSTEM PLAN**

D-101

DRAWING FILE: C:\Users\dmill\OneDrive\GMC\CMOB250034 Wright Smith WWTP Primary Digester #1 Cover Replacement\CAD Files\CAD\DWG\02 Sheets\11 Process\D-103.dwg
PLOTTED: Nov 19, 2025 - 3:41pm

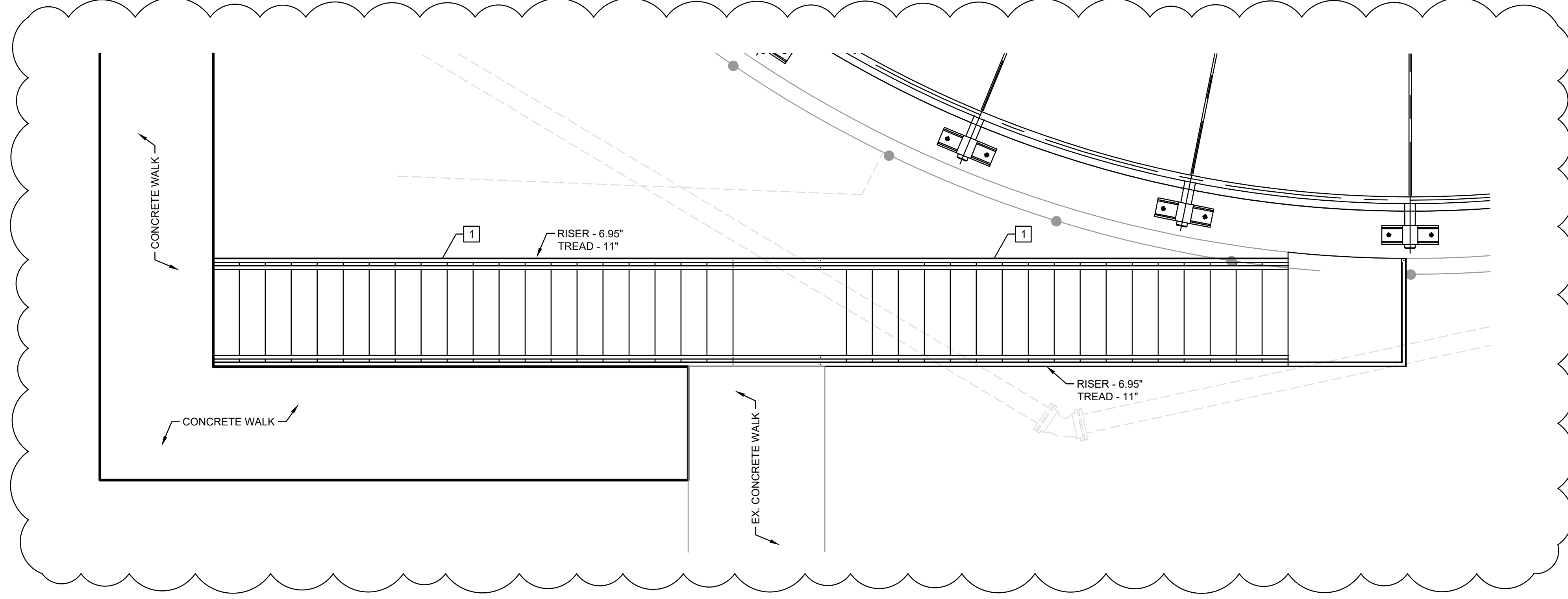

2 ENLARGED PLAN VIEW

D-103 SCALE: 3/8" = 1'-0"

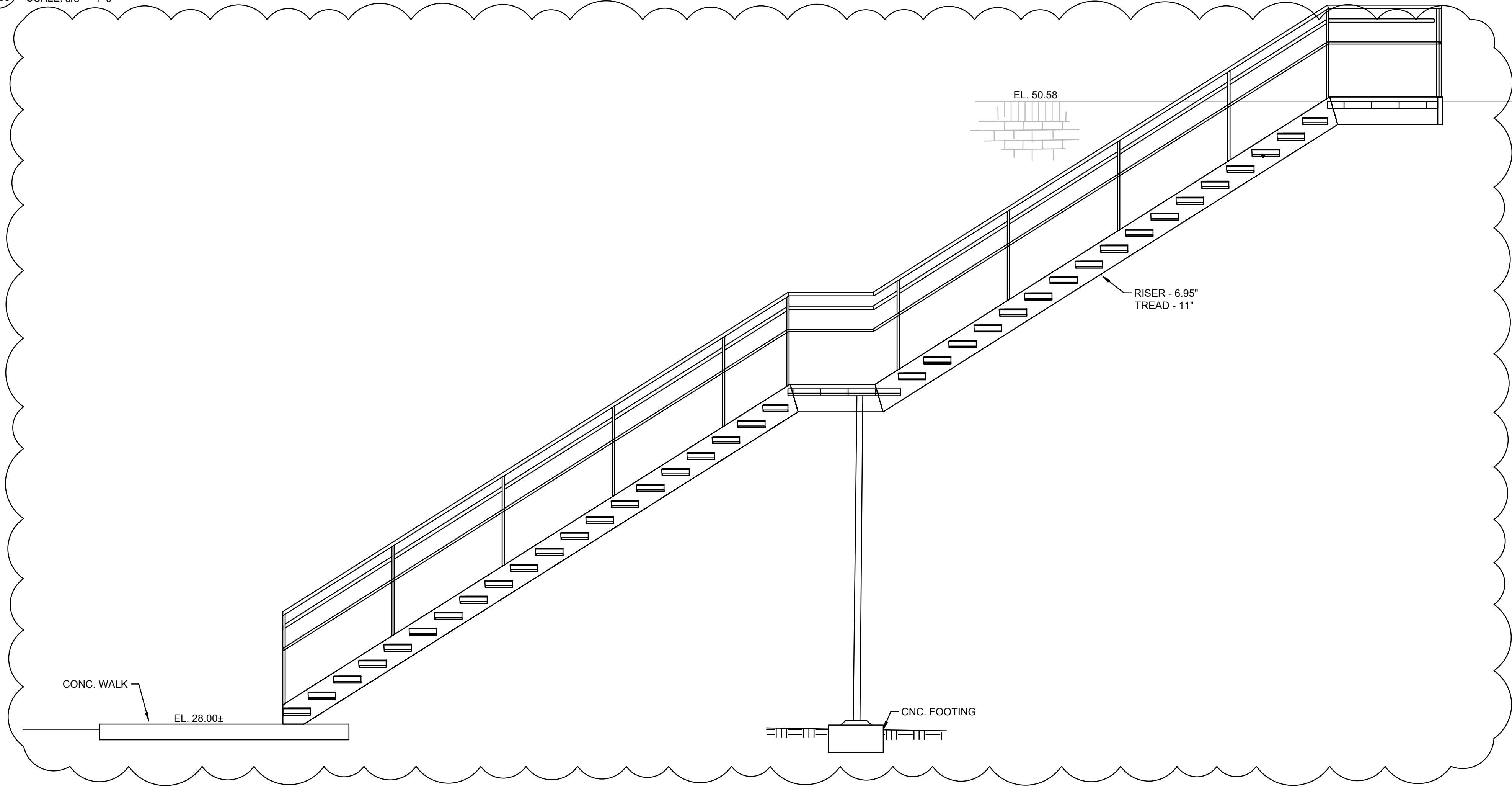

2 SECTION

D-103 SCALE: 3/8" = 1'-0"

NOTES:

1. CONTRACTOR SHALL FIELD VERIFY DIMENSIONS FOR NEW STAIRS.

KEY NOTES: #

1. PREFABRICATED METAL STAIRS W/ RAILING

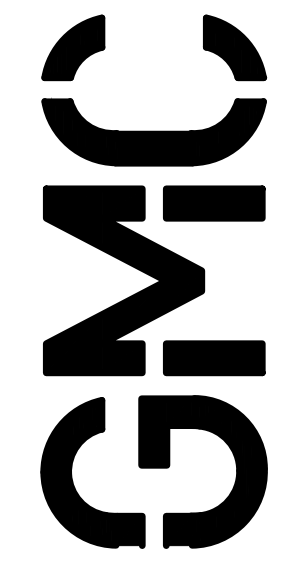

11 North Water Street
Suite 19290
Mobile, AL 36602
T 251.460.4006



ISSUE	DATE
50% SUBMITTAL:	07.16.2025
90% SUBMITTAL:	09.19.2025
BID SET:	10.10.2025
APPENDUM 1	11.19.2025

ENGINEER:	DT
DESIGNER:	DT
DRAWN BY:	CE

WRIGHT SMITH WWTP
PRIMARY DIGESTER #1
COVER REPLACEMENT
MOBILE, AL
MOBILE AREA WATER & SEWER SYSTEM
CMOB250034



PRIMARY DIGESTER #1
- ENLARGED PLAN &
SECTION

D-103